

**SITE PLAN SHOWING LATITUDE & LONGITUDE FOR PROPOSED
G+IV STORIED(HT.-15.475MT.) RESIDENTIAL
BUILDING AT- 1/1A, PRANNATH PANDIT STREET, KOLKATA- 700025,
WARD NO.-72, BOROUGH NO.-VIII, P.S.- BHOWANIPORE.**

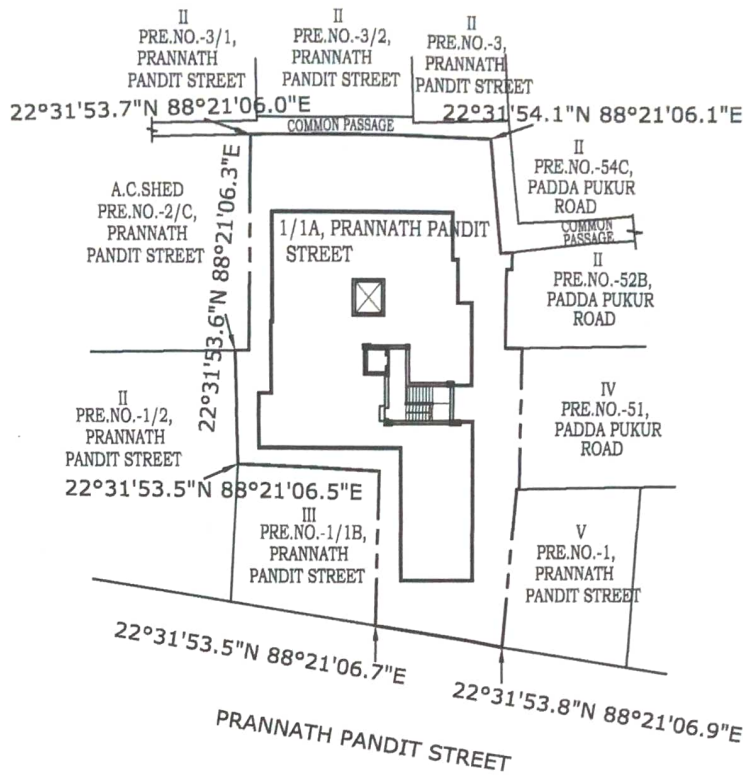

**SITE PLAN
SCALE-1:600**

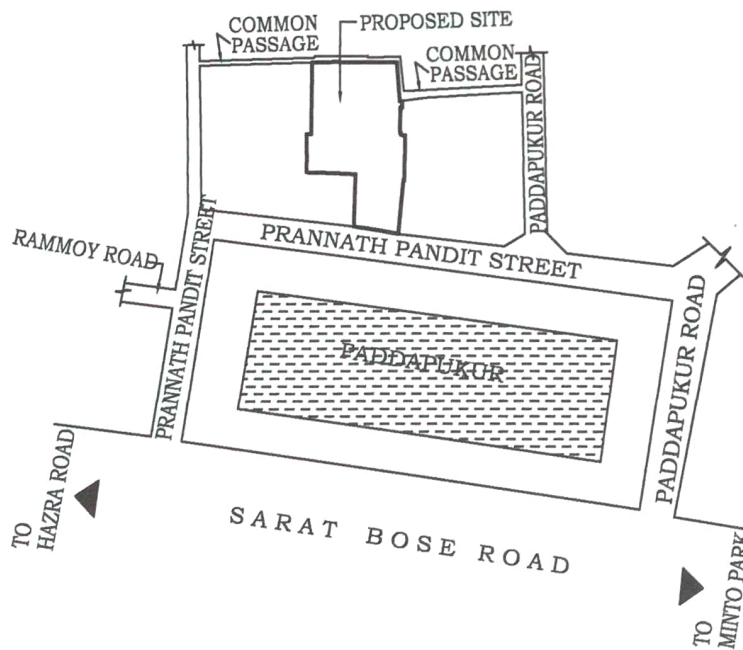

**LOCATION PLAN
SCALE-1:4000**

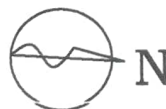

For Swastic Heights Pvt. Ltd.

[Handwritten Signature]
Director